



12X40' RIG MANAGER SUITE

WTRM1240

SKID-MOUNTED SUITE WITH THE COMFORTS OF HOME

The Rig Manager Suite is a spacious, living quarter for staff that work in remote locations for extended periods of time. Modern furnishings and attention to detail ensure that this unit is remarkably similar to your staff's accommodations at home.

STANDARD SPECIFICATIONS

- 12' wide corten steel shell is durable and easy to transport
- (1) in-set steel man doors to meet 11'6" width requirements for easier transportability
- (1) 4' x 3' and (1) 6' x 3' in-set sliding windows increase the amount of natural light inside
- 3" spray foam insulation (R18) on ceiling & walls to maximize heat in cold climates
- Vinyl wrapped drywall creates a clean and durable finish
- Rigid floor insulation for added heat retention
- Vinyl flooring is easy to clean & cost effective
- Durable rubber baseboards to protect the walls from spills
- 3000w of heat between the bedroom & living area, plus 500w of heat in the washroom to keep the space warm in cold climates
- Roller blinds added to control light and heat

- Interior acrylic lens lights evenly diffuse light throughout the space
- Telephone & data hookups for fast connectivity
- 100 amp panel with breakers & hard wire fitting for easy connection to a power source
- Plastic laminate and melamine millwork add durability in moisture-rich environments
- (2) air conditioning units to quickly cool and create a comfortable space
- 30 gal. hot water tank with central plumbing hookups make this unit quick to deploy
- Kitchen includes a fridge, stove, microwave, and double sink for added convenience
- Three-piece bathroom comes with a 3' x 3' shower, toilet, and a 42" vanity to offer the comforts of home
- Built-in bedroom furniture includes double bed, desk with chair, wardrobe, night stand, and side chair to maximize bedroom space

EXECUTIVE PACKAGE

- Exterior LED lighting for safety and security
- 4" spray foam insulation (R24) on ceiling & walls to maximize heat in cold climates
- Interior vapor-proof lighting for added moisture resistance and durability
- Rolled vinyl commercial grade flooring for easy maintenance and clean finish
- Living area furniture including a sofa, side chair, end table, foot stools, built-in desk with chair, storage, 40" TV, and bar stools to comfortably relax during downtime
- Bedside light for late night reading
- Built-in USB outlets to conveniently charge your devices
- Steel studs to improve the lifespan of the structure and prevent rot & mould
- Exterior enamel paint in colour of your choice

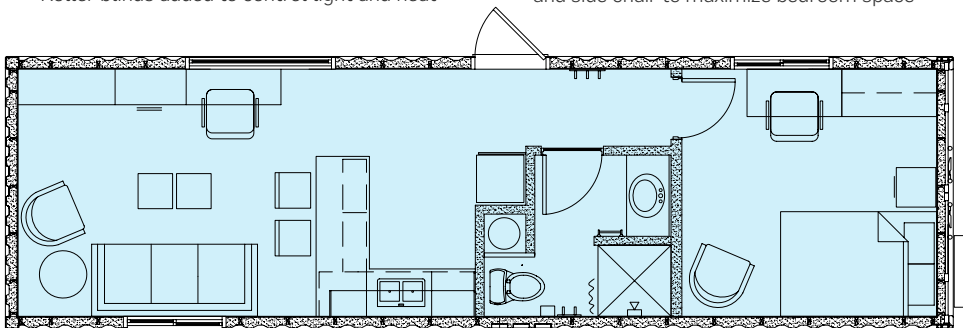

ADD ONS

- + Furniture and equipment
- + Partitions, doors, and windows
- + Washroom or storage
- + Mounting it to a skid



* Specifications are subject to change. Furniture included as noted.